

# The Monument



Newsletter of the  
MORROW COUNTY GENEALOGICAL SOCIETY  
P. O. Box 401  
Mount Gilead, Ohio 43338

Daniel L. Rhodebeck, Editor

\*\* Annual Dues: Single Member = \$5.00 \*\* Joint Membership (2 persons, 1 Monument), \$7.00 \*\*

NOVEMBER 1991

PAGE 13

## COUNTY CENSUS GROWS

The census of Morrow County, Ohio increased by one on Thursday October 24, 1991 at 7:02 a.m. with the birth of

KENT ROBERT RHODEBECK

son of M.C.G.S. members Daniel and Janet Rhodebeck. He weighed 7 pounds & 10½ ounces and was 20½ inches long. The other member of Kent's household is Levi Daniel Rhodebeck, who celebrated his third birthday on November 19. Both boys are the grandsons of Robert & Doris Rhodebeck, of rural Bellville, and Larry & Mary Murphy, of suburban Ontario, Ohio.

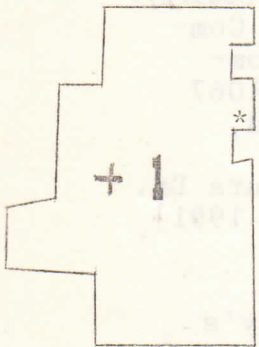

## NEW MEMBER

Ann Booher Dolch, 41 Virginia Avenue, Tiffin, Ohio 44883  
Surnames: BOOKER / BOOHER \* FOUST



## PROGRAM SCHEDULE

Monday November 25. Howard Mitchell: "WALES AND RUSSIA"

We meet in the Community Room of the First Federal Savings & Loan, 70 North Main Street, Mount Gilead, starting at 7:30 p.m. We are now gearing up for our 1992 agenda already. Any suggestions as to topics, speakers, workshops or activities are most welcome. We will be meeting on the fourth Saturdays in January, February and March, at 2:00 p.m., and the fourth Mondays of the month in April, May, August, September, October and November.

## NEW CEMETERY BOOK IN THE WORKS

Our main activity for the Summer of 1991 was collecting material for Volume 4 of MORROW COUNTY, OHIO, TOMBSTONE INSCRIPTIONS. We plan to combine the townships of BENNINGTON, LINCOLN, PERU, and WESTFIELD.

## <<< FIRST FAMILIES REMINDER >>>

Completed applications for FIRST FAMILIES OF MORROW COUNTY are welcome anytime, but the preferred deadline to be considered in time for next year's March luncheon ceremony is 31 December 1991. Blank forms and instructions can be obtained by sending us a long, stamped envelope. Eligibility is based on a person having at least one direct ancestor as a resident of what is now Morrow County before 1851.

L I B R A R Y      U P D A T E

At the September 23rd meeting, we voted to donate \$500.00 to the Mount Gilead Public Library for the purchase of materials for their Genealogy Department, located at 20 East Center Street. Much of what they order will pertain to the five surrounding counties, to help with records pertaining to our years before 1848.

\*\* Recent Acquisitions \*\*

Ohio Marriages, Extracted from the 'Old Northwest Genealogical Quarterly'. Edited by Marjorie Smith. (1977; 350 pp.) Presented by the Morrow County Genealogical Society in Memory of Eugene Douce and Don Killen.

Caledonia and Claridon Cemeteries, Claridon Township, Marion County, Ohio. (1985; 88 pp.) Presented by the Marion Area Genealogical Society. "National Genealogical Society Quarterly", Arlington, Virginia. Complete years for 1958, 1971 through 1975; 1980 through 1990. Incomplete years, 1976 through 1979. [Donations by Maxine Marshall, 1067 Richmond Ave., Marion and Vivian Griffith, 1639 Marion-Waldo Road, Lot 35, Marion, Ohio 43002.]

Ramsey - Keese Family History, by Robert & Dorothy Boger, 952 Laura Dr. Marion, Ohio 43302. (1991; 110 pp.) [Covers years from 1595 to 1991]

ORIGINAL LAND OWNERS --- New Guidebook Available

Researchers delving into the earliest years of Morrow County's history are often interested in the original acquisition of land. To help facilitate this search, a notebook has been assembled for our library. It combines the work of two persons who have diligently extracted the information. The titles are:

ORIGINAL PURCHASERS OF LAND IN RICHLAND COUNTY, OHIO, by Ellsworth H. Morse, Jr. (1966 & 1970) [The pages which cover the townships of Perry, Troy, North Bloomfield, Congress, and a small portion of Gilead, as well as the introductory material were photocopied from the original book in the Ohio Genealogical Society library.]

OHIO LANDS: CHILLICOTHE LAND OFFICE, 1800--1829, by Marie Taylor Clark, C.G. (1984) [This book has been in our library for some time, but the references to those Morrow County townships which lie south of the Greenville Treaty Line may not have been easily found. This was known as the "United States Military Tract".]

Two interesting entries in this latter book are found on page 112. An entire township, described as Range 15 Township 7 (later known as "Chester Township") was deeded to David Jones on 5 March 1805. That comprised 4,000 acres. And a notation was found referring to Range 15, Township 6 (later to be called "South Bloomfield Township"):

CENTRE OF THE STATE OF OHIO. AGREEABLE TO THE CALCULATION MADE BY THE CONGRESS APPRIATED BY THE LEGISLATURE FOR FIXING THE PERMANENT SEAT OF GOVERNMENT.

BARTON      Need info on family of Samuel BARTON, Mt. Gilead Village in 1860 & '70  
 FOGLE      Census (deputy sheriff). He b. ca. 1828 in OH. Wife Mary (Fogle) & dauts. Cassandra, Anna, Adele, Ellen, Sarah, & Minnie.

>>> Mrs. Barbara Jolley, 452 Willow Lane, Mt. Gilead, Ohio 43338



**S U R N A M E   S E A R C H E R S**

(Researchers who have signed the guest books at the courthouse and library)

**GREGORY \*\* WHEELER \*\* BAILEY \*\* SMITH**

>>> Jim Gregory, 200 Constitution Avenue, Fort Collins, CO 80526

**SQUIRES \* CARPENTER \* GREGORY \* SMITH \* MITCHELL (Mathias Jr.) \* HETRICK \* KOON  
HOPPER \* ZABRISKE \* HIGLEY \* TERRY \* VAN SICKLE \* PACKER \* WILLIAMS**

>>> Harry Squires, 57 West Cook Road #3, Mansfield, OH 44907

**IIAMS \*\* Dennis Iiams, 6934 N.W. 11th Court, Ankeny, IA 50021**

**HART \*\* POWELL \*\* KIMMERLY \*\* INSCHO \*\* PEARL \*\* EWERS**

>>> Wilma Leonard, 319 Nora, Bucyrus, OH 44820

**KEEN \* QUAINANCE >>> George Keen, 1223 Hall Ave., Lakewood, OH 44107**

**PITTMAN \* TRUOX (TRUAX) >> James Pittman, R.2, Box 432AD, Spiro, OK 74959**

**KEIGER / KIEGER / KISER \* \* DETEMPLE**

>>> Florence Busswood, 236 W. 2nd St., Apt. 109 N. Vancouver, B.C. Canada V7M1C6

**TERRY, Edward (of Westfield township)**

>>> Frank E. Terry, 19660 Clearview Rd., Spring Hill, KS 66083

**CRANE \* DeWITT \* VAIL >> Patricia Erwin, 2685 Everett Dr., Reno, NV 89503-3912**

**BENEDICT \* EARL \* GUNNING >>> Lois Fry, P.O. Box 1271, Fayetteville, ARK 72702**

**GLADFELTER \*\* HARRUFF \*\* BENNETT \*\* STEVEN**

>>> Arthur Saiter, 6047 Tiverton Square W., Columbus, OH 43229

**YOUNG \* NEWVILLE \* LEE >>> Buck Young, 1618 Lilac Lane, Warsaw, IN 46580**

**NICKERSON \* GOFF >>> Bruce Johnson, 346 Village Green Blvd. #208, Ann Arbor, MI**

**AULD >>> Wilma Gibson, P. O. Box 3345, Flagstaff, AZ 86003**

**WRENN \*\* LOAR \*\* WALDORF \*\* WEBSTER**

>>> Pat & Chuck Wrenn, 3783 Baybridge Lane, Dublin, OH 43017

"LINKS" \*\* Genealogical Inquiries (Not limited to M.C.G.S. Members)

**BEEBE** Writing a BEEBE FAMILY GENEALOGY. My grandfather was William Gamaliel  
**VORHIES** Beebe (1852-1937), who m. M. Roberta, dau of Dr. L.B. Vorhies (1821-1891).  
All bur. Rivercliff Cemetery, Mount Gilead.

>>> Robert G. Beebe, 353 Breeze Hill, Lake Wales, Florida 33853

**GRIFFITH** Need info on Calvin GRIFFITH (b ca 1809 in VA), m Mary Alvira, dau of  
**SPALDING** Jonas & Susanna (Simonds) SPALDING. Westfield tp./Delaware Co. area.  
**SIMONDS** Ch.: William; Chester F. Griffith (1842-1916); Milo H.; Lyman F. Griffith  
**IMAN** (1848-1933); Mary Jane (1854-1900) m Andrew J. Iman; Ellen, b. 1855.

>>> Pam Griffith, 2202 Belote Place, Jacksonville, Florida 32207

**HATTON** Who were parents of John HATTON, who mar. Adaline Wynkoop in Morgan Co.,  
**WYNKOOP** OH in 1842? He d. 1846. Were they James & Sarah Hatton, who lived in  
Morrow Co., ca. 1830 to 1860?

>>> Stephen B. Hatton, 18542 Pierce Terrace, Homewood, Illinois 60430

**FRINGER** Info on George FRINGER (1791-1877) m Rachel Williams (1794-1880) Perry  
**WILLIAMS** tp. My g-gmo was dau Rachel, m Benedict PRESTON.

>>> Irmagene M. Farmer, 3996 Jefferson Street, Riverside, CA 92504-2625

## RESOURCES FOR NORTHEASTERN MORROW

This list was extracted from a seven-page compilation of Richland County, Ohio, materials in The Ohio Genealogical Society Library in Mansfield. The master list was made by Thomas Stephen Neel, office manager. For our purposes, all the listings involving Richland County before 1848 were chosen.

Cemeteries of Guernsey, Knox, **Morrow** & Richland Cos., Ohio. 1956. DAR. Film.  
 1820, 1830, 1840 Census. Film.  
 1820 Manufacturer's Schedule. Film. Guardian's Index 1846-1905. Film.  
 Richland Co. Common Pleas Court Records, 1813 - 1828.  
 Common Pleas Court, Chancery, 1844-1852. Film. Index to Journals, 1820-1850. Film.  
 Journals, 1822 - 1852. Film.  
 Index to Judgment Records, 1820-1876. MSS. Judgment Records, 1820-1849. MSS.  
 Appearance Docket, March Term 1837 only. MSS. Issue Docket 1836-1842. MSS.  
 Appearance Dockets, 1819-1846. MSS. Stray Books, 1836-1843. MSS. Wolf Records.  
 Court Writs, 1828-1834. Commissioner's Journal, 1813 - 1816. Film.  
Richland Co. Abstracts of Wills, 1813-1873. (1974) by Anne Dallas Budd. [This  
 book is also on the shelves of our library in Mount Gilead!]  
 Administrations & Guardianships, 1829-1879, by Maxine Kinton. Wills, 1816-1903.  
 Administration Records, 1813-1885. Film. Administration Index, 1837-1890. Film.  
 General Index to Misc. Probate Records, 1813-1900. Film.  
 Records of Estate Settlements, 1824-1839. MSS.  
 Administrations & Guardianships, 1821-1869. Packets. MSS.  
 Original Purchasers of Land in Richland County. 1966. Ellsworth H. Morse, Jr.  
 Land Grant Records, Canton-Wooster Office. Film. Steubenville Land Office. Film.  
 Tax Duplicates. 1819-1838. Film. Grantee Index, 1814-1855. Film.  
 Grantor Index, 1814-1902 (1814-1855 only last half alphabet). Film.  
 Ohio Tax Lists (combined) 1801-1814. Film. Tax List, 1836. MSS.  
 Auditors Record of Land Payments, 1828-1853. MSS.  
 Marriages, 1813-1869. DAR. Marriages, 1813-1930. Film. Marriages for  
 the Year 1840 Found in Supreme Court Docket. Donna Fidler.  
 Marriage Index, Direct, 1815-1940. Film. Reverse, 1815-1940. Film.  
 NEWSPAPERS: Mansfield Gazette, 10 July 1823 - 30 Aug 1827. MSS. Gazette  
 Abstracts, 1823 - July 9, 1825. Mansfield Gazette and Richland Farmer,  
 6 September 1827 - 14 September 1831. MSS.  
 The Western Sentinel and Richland County Weekly Advertiser, 26 May 1830 --  
 5 December 1832. MSS.

Morrow Co. Genealogical Society  
 P. O. Box 401  
 Mount Gilead, Ohio 43338

